

NOTES: UNLESS OTHERWISE SPECIFIED

1. 12 GA HRS BODY  
W/ 1" DRAIN HOLE @ RIGHT SIDE [OPTIONAL]
2. 14 GA HRS BEAR-PROOF LIDS
3. 1/2"  $\phi$  HRS ROUND BAR HANDLES
4. 1/4" HRS HINGE PLATES
5. 3/4"  $\phi$  SCH 40 BLACK PIPE HINGES
6. 3/16" HRS BUMPER PLATES
7. 1-1/2" x 2-1/2" x 14 GA. HRS RECT TUBE TRIM
8. 1/2"  $\phi$  SCH 40 BLACK PIPE LOCK-BAR [NOT SHOWN FOR CLARITY]
9. 3/4"  $\phi$  HRS ROUND BAR HINGE-PIN [NOT SHOWN FOR CLARITY]
10. 14 GA HRS SLIDING BACK DOOR [OPTIONAL][NOT SHOWN FOR CLARITY]
11. MECHANICAL QUICK-RELEASE SYSTEM [OPTIONAL][NOT SHOWN FOR CLARITY]
12. 10 GA HRS SKID, PADS, LIFT-POCKETS, RAIL STIFFENERS, POCKET GUSSETS, & LIFT POCKET CHANNELS.
13. POWDER COAT PER CUSTOMER SPECIFICATIONS
14. WEIGHT SPECIFICATIONS FOR UNIT EXCLUDING OPTIONS & HARDWARE TOTALS=1,225.093 LBS.

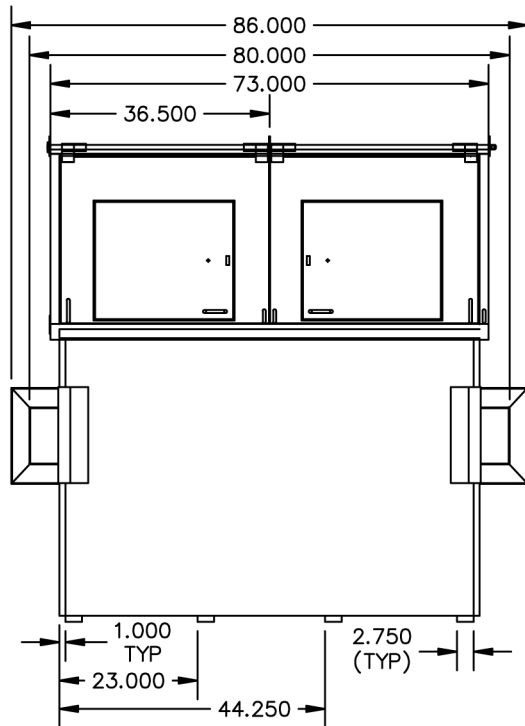

FRONT

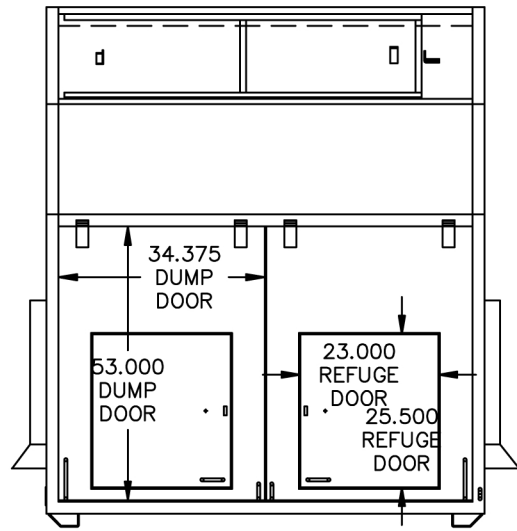
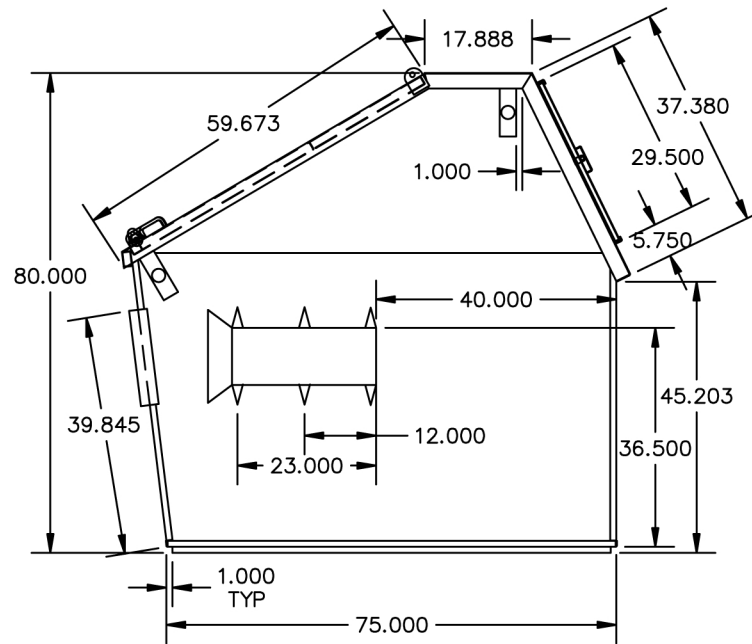

SIDE

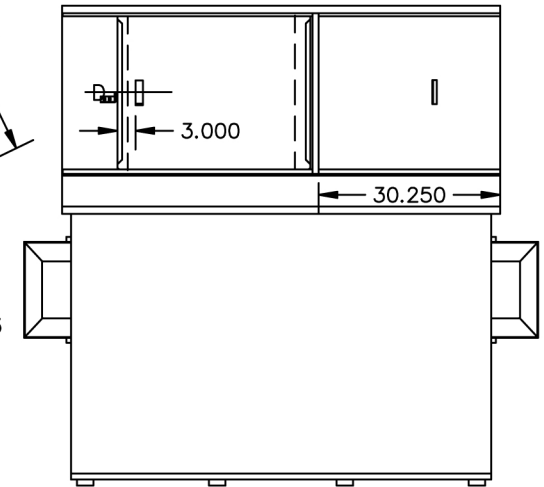

REAR

